

abbotFox



Lindley Close, Norwich
Offers In Excess Of £225,000

“

We are a team of genuine individuals who hold a deep passion for both property and marketing. Collectively, we bring over 70 years of experience in the property market of Norfolk and Suffolk. Our affection for both counties runs deep, and we are enthusiastic about sharing our passion with you.

Colin McKenzie | **Branch Partner**







THE DETAIL _____

abbotFox presents this modern, two bedroom home. An ideal opportunity for any first time buyer, this property is situated within a quiet residential close in the sought after area of Old Catton.

The accommodation comprises; an entrance hall that opens into a modern kitchen and spacious lounge diner to the ground floor, The first floor offers two generous double bedrooms and a family bathroom. Externally, the frontage offers ample off road parking to the front, and a generous rear garden that allows for scope for extension (STPP). An internal viewing comes highly recommended to appreciate this home.





THE HIGHLIGHTS _____

- Semi-detached house
- Two double bedrooms
- Spacious living accommodation
- Generous gardens
- Popular residential location
- Ideal first time buy

Approx Gross Internal Area
56 sq m / 605 sq ft

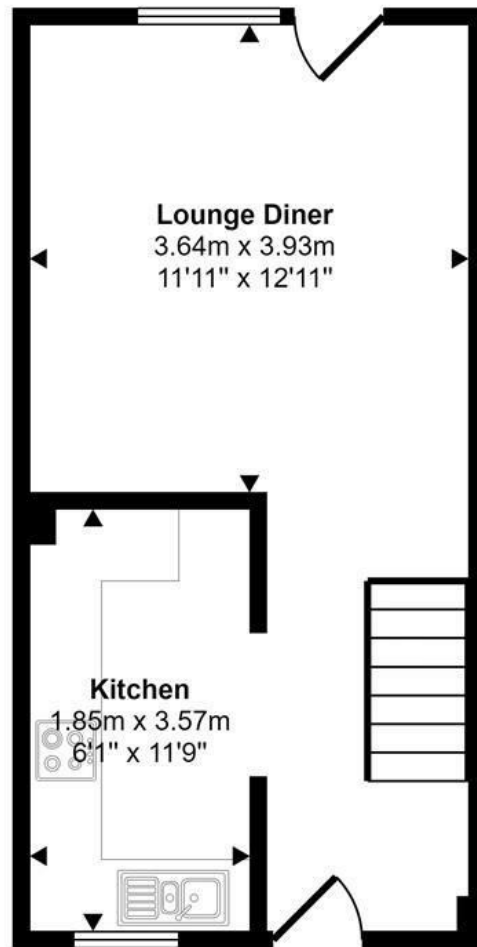

Ground Floor
Approx 28 sq m / 301 sq ft

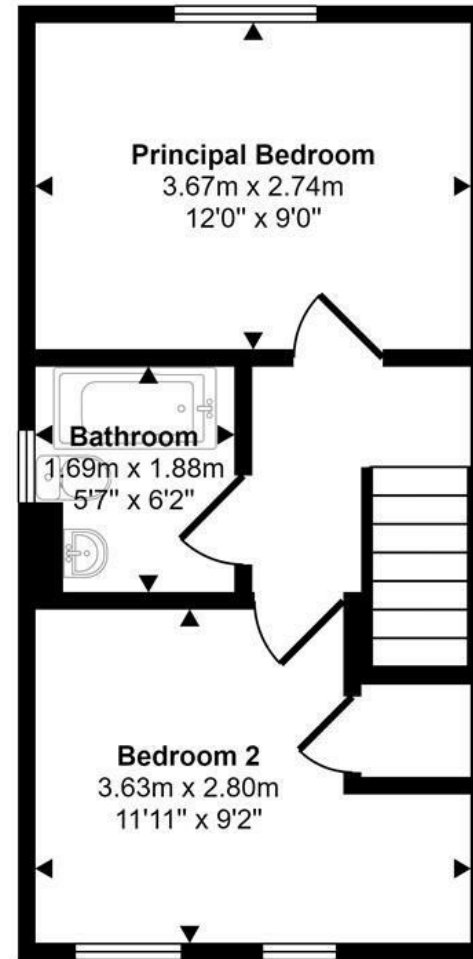

First Floor
Approx 28 sq m / 304 sq ft

This floorplan is only for illustrative purposes and is not to scale. Measurements of rooms, doors, windows, and any items are approximate and no responsibility is taken for any error, omission or mis-statement. Icons of items such as bathroom suites are representations only and

Let's talk

01603 660000

sales@abbotfox.co.uk

@abbotfox

EPC RATING - C

Disclaimer – In accordance with the Property Misdescriptions Act, the company abbotFox gives notice that all descriptions, references to condition, necessary permissions for use and other details are given in good faith and believed to be correct, but any purchaser should not rely on them as statements of fact, and must satisfy themselves by inspection or other means, as to their accuracy.